

# Bluetooth Audio Systems Manual



## ■ Contents

[Parts overview](#)

**For installers**

[Installing Speakers](#)

[Installing Bluetooth Amplifier](#)

**For users**

[Set up for use](#)

[Lock](#)

## ■ Parts overview

The parts included differ depending on the type of audio system. For example, some sets do not include the speakers.

### Bluetooth Amplifier

- BMN Type Bluetooth Amplifier
- DC Adaptor
- Antenna

### Speaker set

- Rumba, Samba, Zumba or Twist Speakers
- Speaker wire
- Speaker template hole size

## ■ Installing Speakers

There are a few important points to bear in mind when installing Bluetooth audio system speakers.



- Make sure that the speaker has enough space behind the ceiling.
- The Bluetooth amplifier is placed behind the ceiling.
- A good Bluetooth reception must be present.
- An electrical outlet must be present behind the ceiling.

When these requirements are met, the speakers can be installed in the ceiling without any problems.

1. Use the template to determine the hole in the ceiling and saw/cut it out.

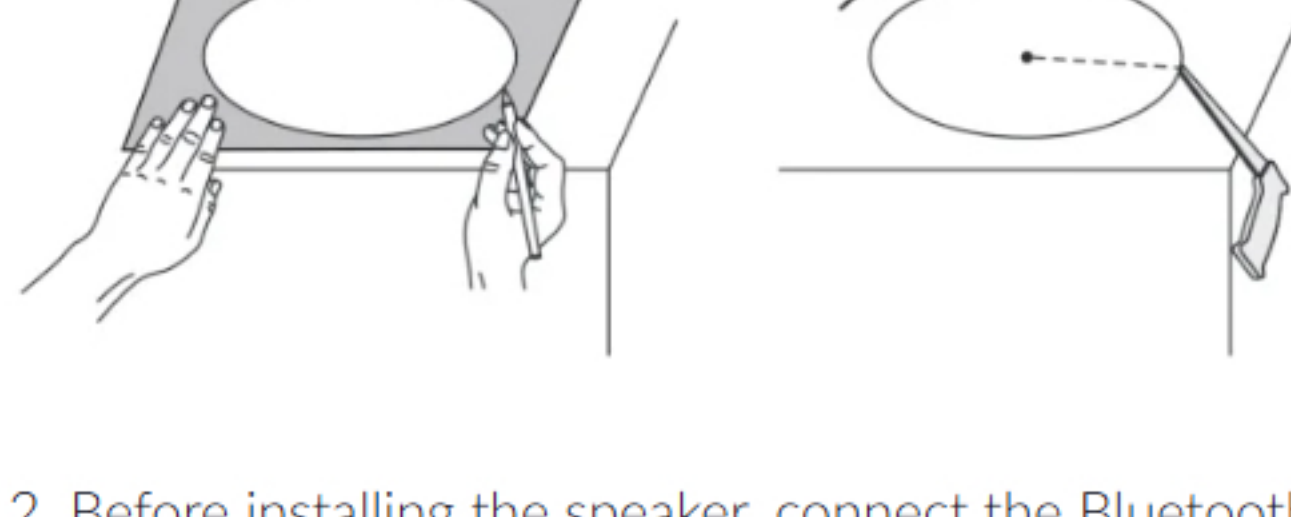

2. Before installing the speaker, connect the Bluetooth amplifier and place it through the speaker hole on top of the ceiling. See [next section](#) for details.

3. Connect the speaker wire to the speaker.



4. Place the speaker.



### Rumba and Twist speakers

The speakers are equipped with a clamping system. Open the clamps and put them through the hole. The speaker will lock itself in place.

### Samba and Zumba speakers

Place the speaker in the hole. Using a screwdriver, tighten the 4 screws. This will open up the hooks on the back and secure the speaker in place.

**CAUTION!** Use a screwdriver, not a screw machine.

## ■ Installing Bluetooth Amplifier

The Bluetooth amplifier is usually placed on top of the ceiling. Because of this, there are a few important points that need to be taken into account.



- A good Bluetooth reception must be present.
- If there is no good Bluetooth reception behind the ceiling, you can use the Bluetooth antenna extension set.
- An electrical outlet must be present behind the ceiling.

Below, we describe the step-by-step plan for connecting the cables to the amplifier.

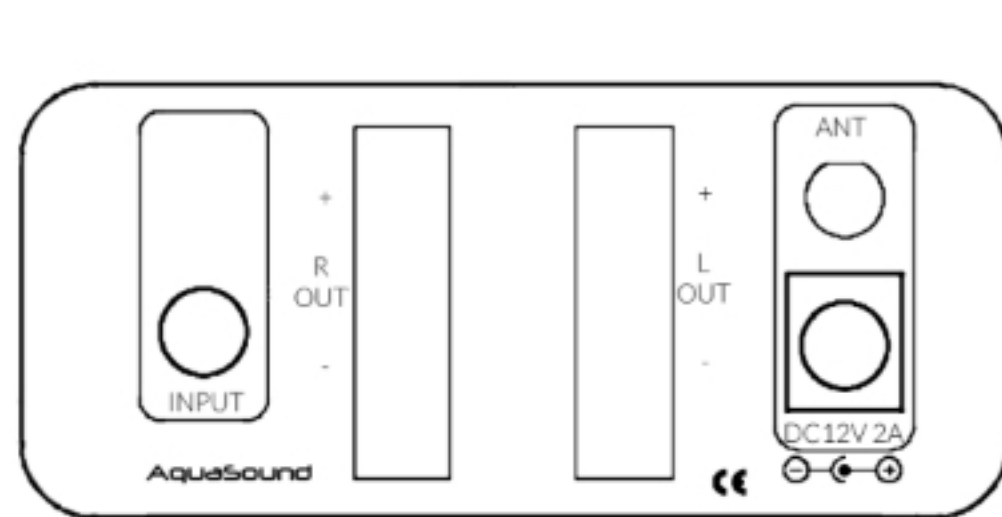

1. Cut the speaker cable to size and strip the ends.
2. Connect this to the amplifier. Red in plus (+), black in minus (-).
3. Screw the antenna on.
4. If an AquaSound TV is present, it can now be connected to the INPUT.
5. Connect the adaptor and plug it into the mains.

Adjust the volume knob on the front of the amplifier to a level where you still have a pleasant listening experience at maximum volume. This is not 100 per cent, but rather 60 or 70 per cent. The easiest way to do this is to pair the controller with the amplifier via Bluetooth and play the sound at maximum volume. Now turn the volume knob back to a level where the sound is comfortable to listen to.

After this, the Bluetooth amplifier can be placed on top of the ceiling through the speaker hole.

## ■ Set up for use

Using a Bluetooth Audio System is very simple. Pairing works in the same way as with Bluetooth wireless earphones, headphones and speakers. Smartphones can connect by going to the Bluetooth settings and finding the AquaSound system there.

## ■ Lastly

With this, your Bluetooth audio system is ready for hours of listening pleasure! In the unlikely event that you encounter problems that you cannot solve with this manual, please do not hesitate to [contact us](#).

If you are satisfied with our products, we would like to invite you to leave a review on Google. [Press here to go to the review page](#).

As a thank you for your review, every month we raffle off a **free** waterproof [AquaSound Sound-Bar](#) worth €299 among the best entries!